

AMERICAN PROFESSIONAL II TELECASTER® (011394XXX)

PARTS LAYOUT

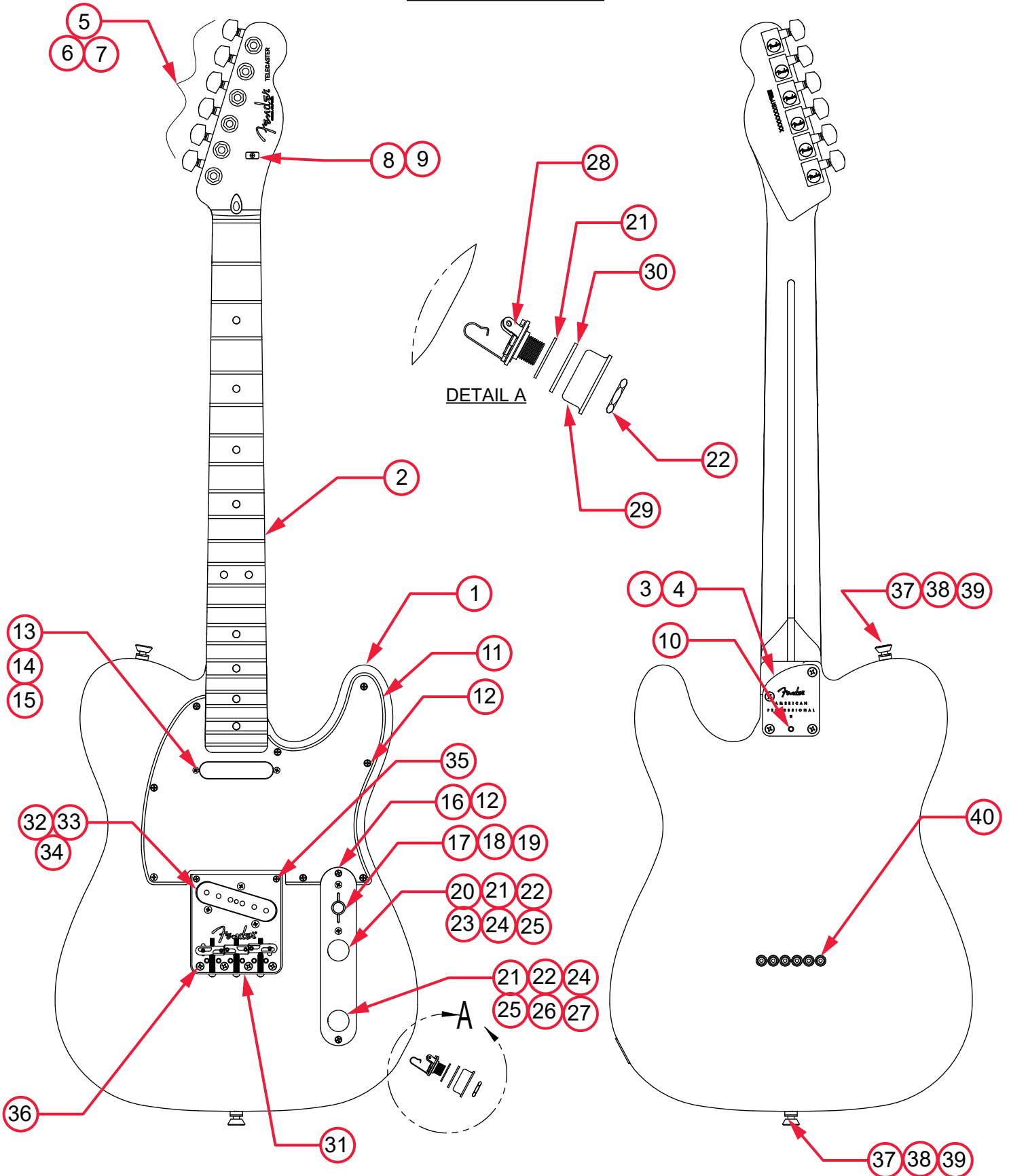

AMERICAN PROFESSIONAL II TELECASTER® (011394XXX)

PARTS LIST

REF#	DESCRIPTION	PART NUMBER
1	BODY AM PRO II TELE 3TSB	7718237500
1	BODY AM PRO II TELE OWT	7718238505
1	BODY AM PRO II TELE MYST SFG	7718238518
1	BODY AM PRO II TELE MERC	7718238555
1	BODY AM PRO II TELE DK NIT	7718238561
1	BODY AM PRO II TELE BLK	7718238506
1	BODY AM PRO II TELE RSTD PINE	7718240563
1	BODY AM PRO II TELE MBL	7718238519
1	BODY AM PRO II TELE BTB	7718240550
1	BODY AM PRO II TELE SSB	7718240547
2	NECK ASSY AM PRO II TELE RW	7718240000
2	NECK ASSY AM PRO II TELE MPL	7718241000
3	PLATE NECK AM PRO II W/TILT CHR	7718160000
4	SCREW SMA 8 X 1-3/4 OHP NI	0015636049
5	KEY GTR DUAL PIN MTG SET (2) LONG (4) SHORT W/HDWR	0990820100
6	WASHERS KEY (6)	0053106049
7	BUSHINGS KEY (6)	0058820049
8	STRING TREE AM ELITE GTR	7708381000
9	SCREW SMA 2 X 9/16 FHP NI	0051621000
10	SET SCREW 1/4-20 X 3/8 OP NI HEX	0031571049
11	PICKGUARD AM STD TELE BRN SHELL	0041627000
11	PICKGUARD AM STD TELE AW/B/AW	7716789000
11	PICKGUARD AM STD TELE BLK 1-PLY	7718247000
11	PICKGUARD AM STD TELE B/W/B	0073054000
11	PICKGUARD AM STD TELE MG/B/MG	0056083000
12	SCREW AMAB 4 X 1/2 OHP NI	0015578049
13	PICKUP ASSY AM PRO II SHAW TELE NK	7718245000
14	SCREW MACH 4-40 X 7/8 RHP NI	7700222000
15	TUBING SIL RUB CUT RED .625	0068156000
16	PLATE CONTROL TELE VINT ALUM CHR	0093823000
17	SWITCH 3-WAY LEVER	0992041000
18	SCREW MACH 6-32 X 5/8 RHP NI	0994925000
19	KNOB SWITCH VINT TELE BAKELITE	0093602049
20	CONTROL 250K 10% AUDIO METAL	0990831000
21	WASHER LOCK INTL 3/8 X .687	0016436049

*= NOT PICTURED IN DIAGRAM



AMERICAN PROFESSIONAL II TELECASTER® (011394XXX)

REF#	DESCRIPTION	PART NUMBER
22	NUT HEX 3/8-32 X 3/32 TK NI	0016352049
23	PCB ASSY TREBLE BLEED AM PRO STRAT /TELE	7711092000
24	KNOB 52 TELE KNURLED UPG CHR	0094040049
25	CAP MPF RDL .22µF 250V 10%	0024832049
26	POT W/LTCH PUSH SWTCH PLN SHFT 250KA	7713119000
27	SPACER NYLON .25OD X .140ID X .188L	7720479000
28	JACK PHONE CIRCUIT 11	0021956049
29	FERRULE JACK STD TELE CHR	0021452000
30	RETAINER JACK NI PLT	0010355069
31	BRIDGE ASSY AM PRO II TELE CHR	7718248009
31A	BRIDGE PLATE AM PRO II TELE CHR	7718249000
31B	BRIDGE SECTION AM PRO II TELE BULLET END	7718250000
31C	BRIDGE SECTION AM PRO TELE REVERSE	7710421000
31D	SCREW M 6-32x1-1/4 RHP NI	0015834049
31E	SPRING COMPRESSION 1 1/16 #144	0018689049
31F	SCREW SET 6-32 x 5/16 OP NI HEX	7710422000
31G	SCREW SET 6-32 x 3/8 OP NI HEX	7710028000
32	PICKUP ASSY AM PRO II SHAW TELE BRIDGE	7718252000
33	TUBING LATEX CUT .425 X 1/8	0039409000
34	SCREW MACH 6-32 X 5/8 RHP NI	0015800049
35	SCREW SMA 3 X 1/2 OHP NI	0027956049
36	SCREW SMA 6 X 1 OHP NI	0037952049
37	WASHER FELT BLACK	0994929000
37	WASHER FELT WHITE	0994930000
38	BUTTON STRAP CHROME SET W/HDWR	0063267049
39	SCREW WOOD 6 X 1 OHP NI	0016188049
40	FERRULE STRING RETAINER NI SET	0994918000
*	CASE MOLDED AM ELITE GTR	7708545000
*	BRIDGE COVER AM PRO TELE CHR	7709972000
*	WRENCH HEX KEY 1/16 (SADDLE HEIGHT ADJUST)	0021109049
*	WRENCH HEX KEY 1/8 (TRUSS ROD ADJUST)	0023811049

*= NOT PICTURED IN DIAGRAM







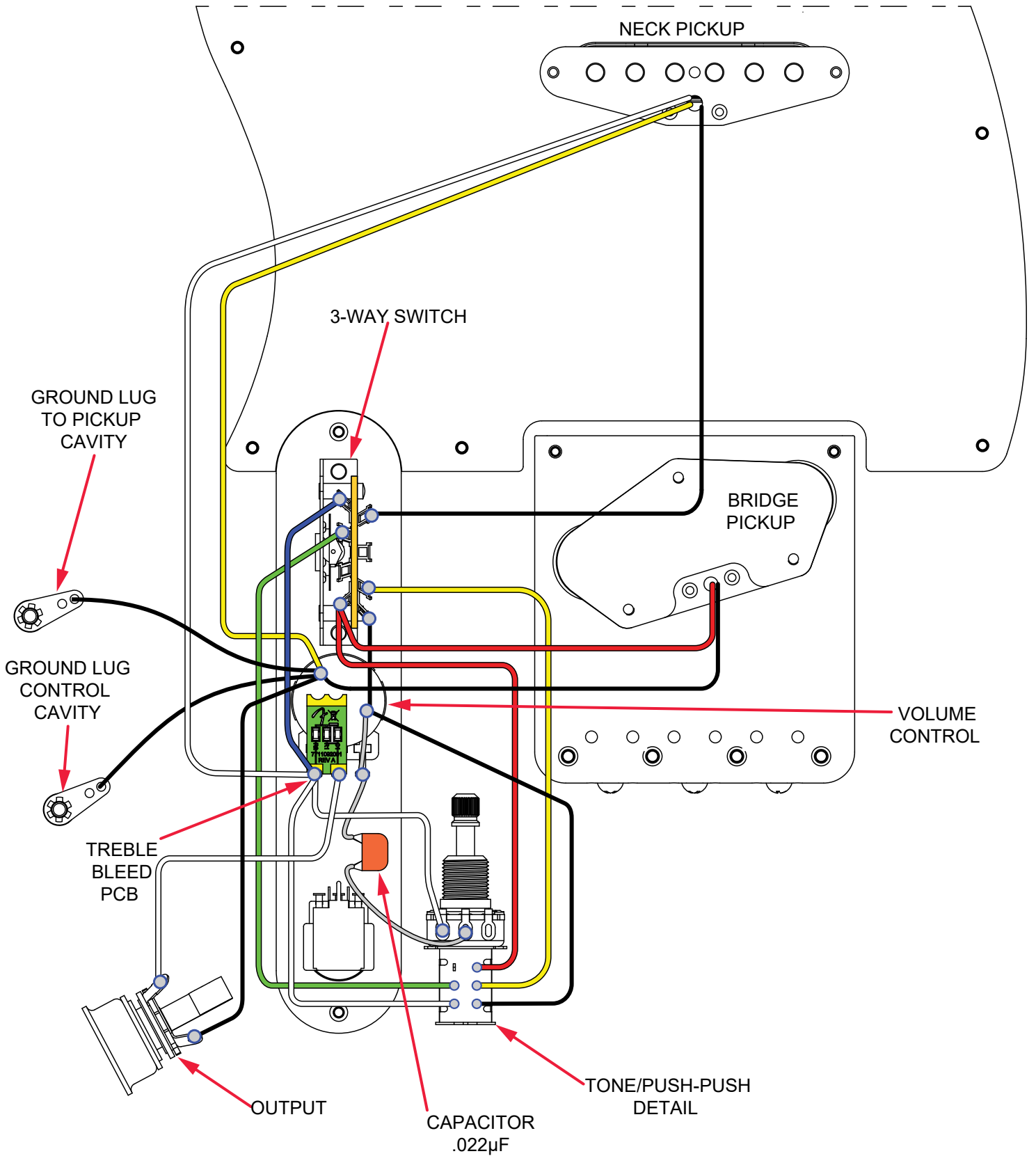

AMERICAN PROFESSIONAL II TELECASTER® (011394XXXX)



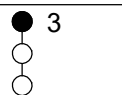
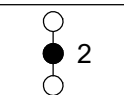
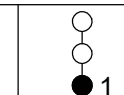

WIRING ASSEMBLY

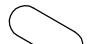

AMERICAN PROFESSIONAL II TELECASTER® (011394XXX)

SWITCH AND CONTROL FUNCTION

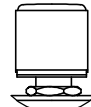
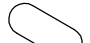
	 3	 2	 1	3-WAY SWITCH POSITION
NECK PICKUP				
BRIDGE PICKUP				
POSITION 2 NECK & BRIDGE PICKUP IN PARALLEL				

NECK PICKUP				
BRIDGE PICKUP				
POSITION 2 NECK & BRIDGE PICKUP IN SERIES				

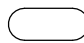
	PICKUP ON
	PICKUP OFF

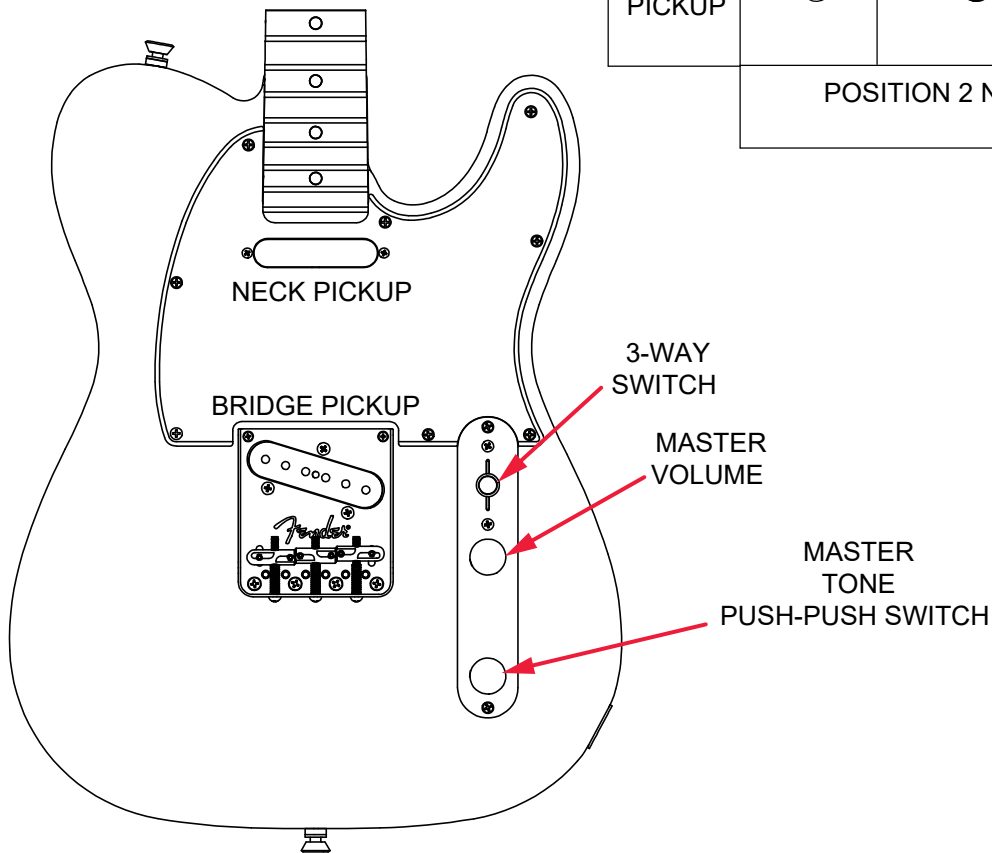

AMERICAN PROFESSIONAL II TELECASTER® (011394XXXX)

ADDITIONAL SPECIFICATION DETAIL

FRET SIZE: JUMBO NARROW
(FRET DIMENSIONS ARE BEFORE INSTALLATION)

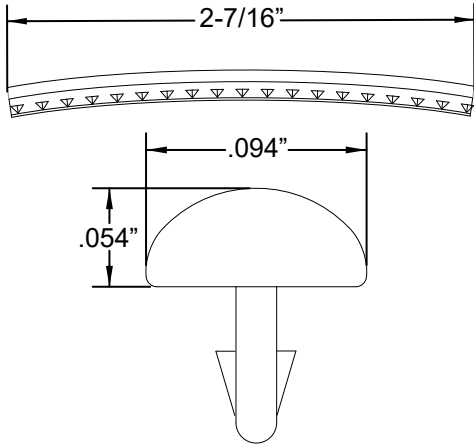

PLEASE NOTE: AS EACH NECK IS SANDED & FINISHED BY HAND, THICKNESS DIMENSIONS MAY VARY SLIGHTLY FROM THOSE SHOWN.

NECK PROFILE: MODERN DEEP "C"

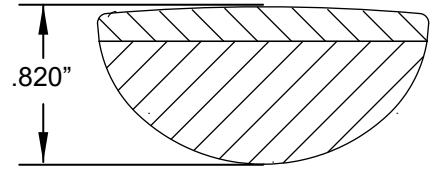

1ST FRET PROFILE

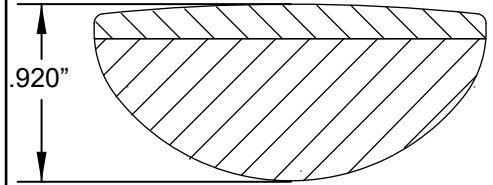

12TH FRET PROFILE

TUNING MACHINE SET W/HDWR P/N 0990820100
OUTER SHAFT DIAMETER .394"

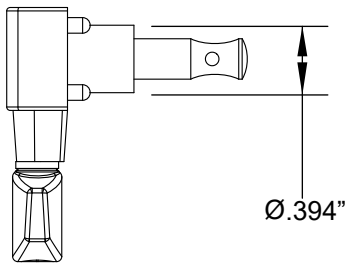

TUNING MACHINE THRU-HOLE
INNER DIAMETER .404"

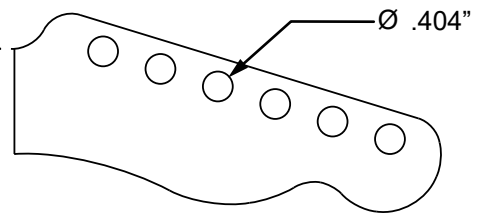

SADDLE HEIGHT ADJUSTMENT WRENCH:
1/16" HEX KEY P/N 0021109049

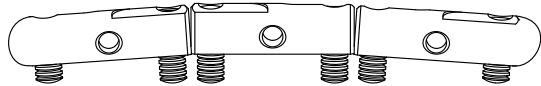
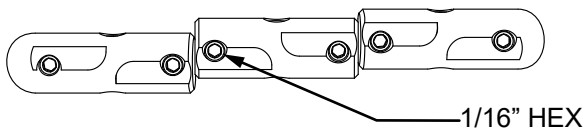

SADDLE HEIGHT SET SCREWS

TALL: P/N 7710428049 SHORT: P/N 7710422049

TRUSS ROD NUT P/N 0994943000
TRUSS ROD ADJUSTMENT WRENCH:
1/8" HEX KEY P/N 0023811049

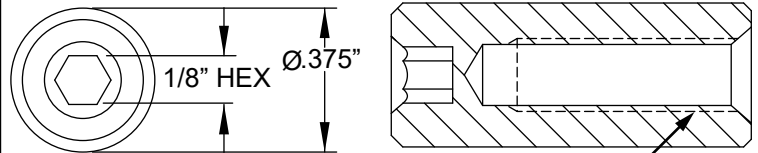

**10-32
THREAD**

LOGO: AMERICAN PRO TELE
APPLIED UNDER THE FINISH



PICKUP SPECIFICATIONS

POSITION	MAGNETS	DC RESISTANCE	POLARITY
NECK	ALNICO 5 & 2 UNBEVELED	5.6 - 6.2KΩ	NORTH
BRIDGE	ALNICO 5 & 2 UNBEVELED	7.2 - 7.8KΩ	SOUTH